

## Checking multi-function switch -F125- with 8-pin connector

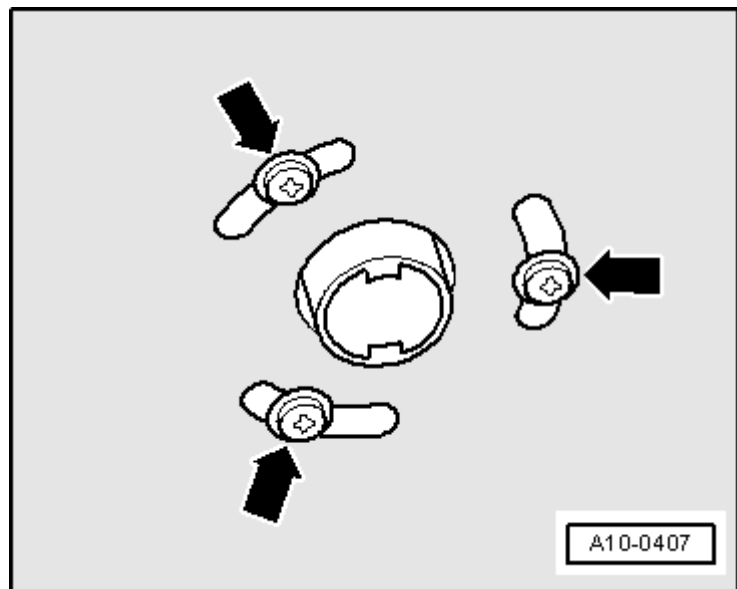

### Note

- ♦ Read measured value block 004 for multi-function switch before performing electrical check.
- ♦ Make sure that selector lever cable is properly adjusted  
→ Automatic gearbox 01V, front-wheel drive and four-wheel drive; Rep. Gr.37.
- On vehicles fitted with auxiliary heater, remove screws -arrows- securing exhaust pipe of auxiliary/ additional heater to noise insulation.



- Release fasteners -arrows- and detach noise insulation.

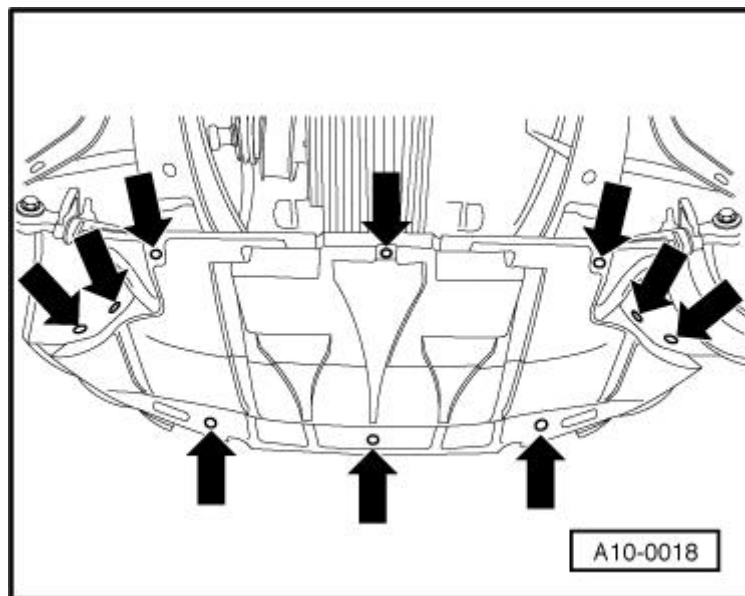

- Unplug connector -2- of multi-function switch -F125- at front left of gearbox.

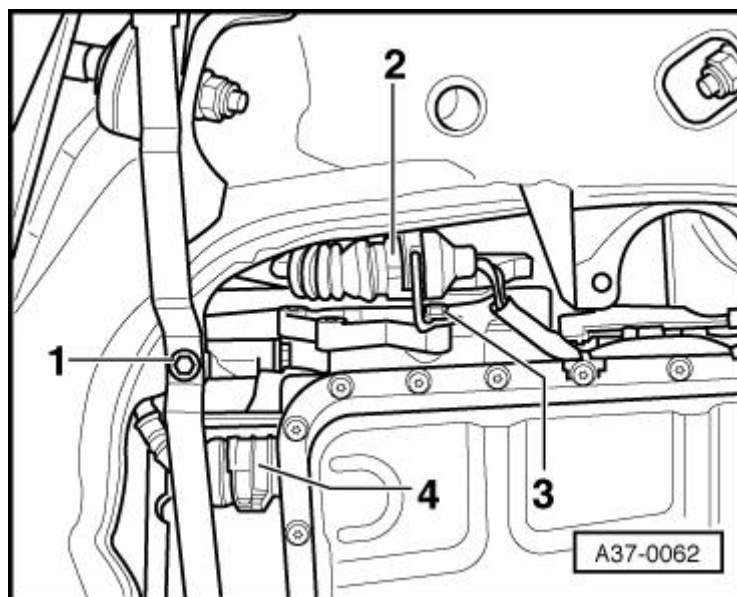

Contact assignment at 8-pin connector of multi-function switch -F125-.

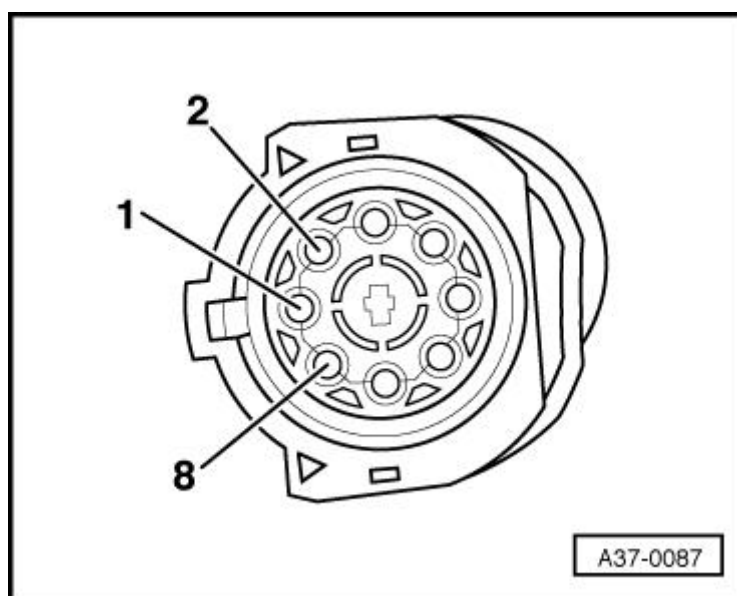

### Test step No. 1

| Contacts on -F125- | Items tested                 | Test conditions and additional steps  | Specification        | Fault rectification if readout does not match specification   |
|--------------------|------------------------------|---|----------------------|---|
| 1 + 2              | Multi-function switch -F125- | <ul style="list-style-type: none"> <li>Ignition switched off</li> <li>Switch to resistance measuring range</li> </ul> |                      |   |
|                    |                              | – Selector lever in "P", "N", "D"   | Less than 1 $\Omega$ | <ul style="list-style-type: none"> <li>Check connector at multi-function switch for contact corrosion, moisture or loose fitting</li> <li>Check selector lever cable adjustment → Automatic gearbox 01V, front-wheel drive and four-wheel drive; Rep. Gr.37</li> <li>Renew multi-function switch → Automatic gearbox 01V, front-wheel drive and four-wheel drive; Rep. Gr.37</li> </ul> |
|                    |                              | – Selector lever in "R", "4", "3", "2"  | $\infty \Omega$      |   |
| 1 + 3              |                              | – Selector lever in "R", "N", "4"   | Less than 1 $\Omega$ |   |
|                    |                              | – Selector lever in "P", "D", "3", "2"  | $\infty \Omega$      |   |
| 1 + 4              |                              | – Selector lever in "N", "D", "4", "2"  | Less than 1 $\Omega$ |   |

|       |  |  |                      |  |
|-------|--|--|----------------------|--|
| 1 + 5 |  | – Selector lever in “P”, “R”, “3”      | $\infty \Omega$      |  |
|       |  | – Selector lever in “D”, “4”, “3”      | Less than 1 $\Omega$ |  |
|       |  | – Selector lever in “P”, “R”, “N”, “2” | $\infty \Omega$      |  |

**Test step No. 2**

| Contacts on -F125- | Items tested                                 | Test conditions and additional steps  | Specification        | Fault rectification if readout does not match specification   |
|--------------------|--|---|----------------------|---|
| 6 + 7              | P/N signal from multi-function switch -F125- | <ul style="list-style-type: none"> <li>Ignition switched off</li> <li>Switch to resistance measuring range</li> </ul> | $\infty \Omega$      | <ul style="list-style-type: none"> <li>Check connector at multi-function switch for contact corrosion, moisture or loose fitting</li> <li>Check selector lever cable adjustment → Automatic gearbox 01V, front-wheel drive and four-wheel drive; Rep. Gr.37</li> <li>Renew multi-function switch → Automatic gearbox 01V, front-wheel drive and four-wheel drive; Rep. Gr.37</li> </ul> |
|                    |  | – Selector lever in “R”, “D”, “4”, “3”, “2”   |                      |   |
|                    |  | – Selector lever in “P”, “N”  | Less than 1 $\Omega$ |   |

**Test step No. 3**

| Contacts on -F125- | Items tested   | Test conditions and additional steps  | Specification        | Fault rectification if readout does not match specification   |
|--------------------|--|---|----------------------|---|
| 1 + 8              | Reversing light signal from multi-function switch -F125- | <ul style="list-style-type: none"> <li>Ignition switched off</li> <li>Switch to resistance measuring range</li> </ul> | $\infty \Omega$      | <ul style="list-style-type: none"> <li>Check connector at multi-function switch for contact corrosion, moisture or loose fitting</li> <li>Check selector lever cable adjustment → Automatic gearbox 01V, front-wheel drive and four-wheel drive; Rep. Gr.37</li> <li>Renew multi-function switch → Automatic gearbox 01V, front-wheel drive and four-wheel drive; Rep. Gr.37</li> </ul> |
|                    |  | – Selector lever in “P”, “N”, “D”, “4”, “3”, “2”  |                      |   |
|                    |  | – Selector lever in “R”   | Less than 1 $\Omega$ |   |

**Checking voltage supply of multi-function**

**switch**

- Connect multimeter for voltage measurement between contacts -1- and -6- of the 8-pin connector.
- Switch on ignition.
- Specification: approx. battery voltage.

If readout does not match specification:

- Repair wiring → [Current flow diagrams](#), [Electrical fault finding and Fitting locations](#).

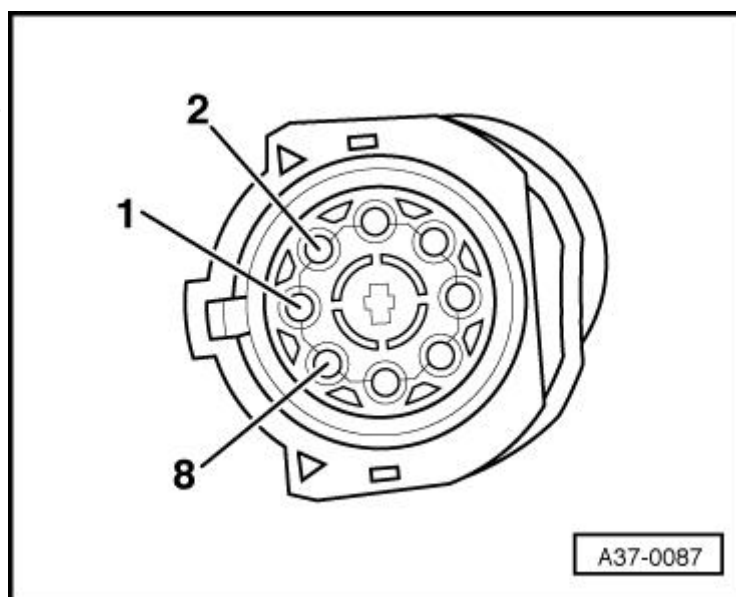
**Checking wiring between 8-pin connector for multi-function switch and gearbox control unit**

- Connect adapter -V.A.G 1598/20- (test box) to automatic gearbox control unit - J217- → [Chapter](#).
- Connect multimeter for resistance measurement between contacts on the 8-pin connector and the sockets on adapter - V.A.G 1598/20- (test box), as shown in the following table.

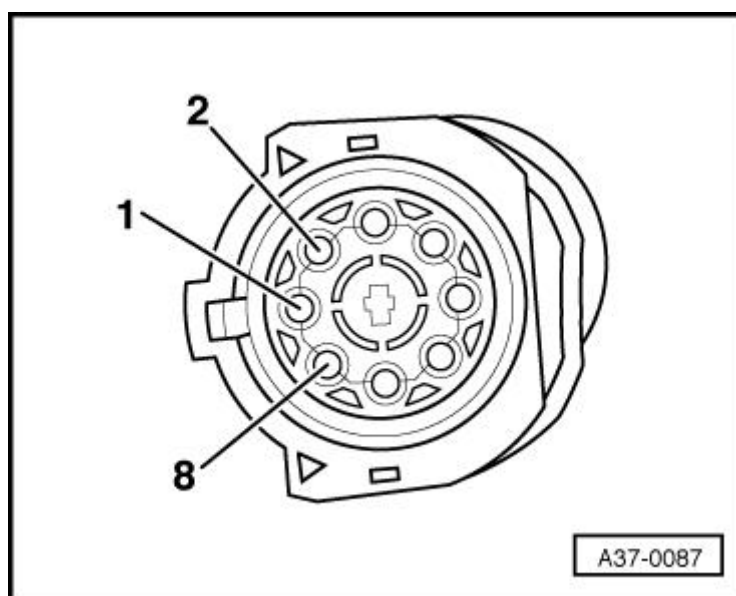

| Connector Contact | Adapter -1598/20- (test box) Socket        | Specification          |
|-------------------|--|------------------------|
| 1                 | 54 and 55                                  | Less than 1.5 $\Omega$ |
| 2                 | 36   | Less than 1.5 $\Omega$ |
| 3                 | 8  | Less than 1.5 $\Omega$ |
| 4                 | 37   | Less than 1.5 $\Omega$ |
| 5                 | 9  | Less than 1.5 $\Omega$ |
| 6                 | 6, 34 and 28 if necessary                  | Less than 1.5 $\Omega$ |
| 7                 | → <a href="#">Anchor</a> , Test step No. 2 |                        |
| 8                 | → <a href="#">Anchor</a> , Test step No. 3 |                        |

**Note**

- ♦ If readout does not match specification, rectify open circuit in

wiring according to current flow diagram and check connector for contact corrosion, moisture and leaks.

- ◆ If readout obtained in this wiring check matches specification, the multi-function switch -F125- must be renewed  
→ Automatic gearbox 01V, front-wheel drive and four-wheel drive; Rep. Gr.37.